

High Tonnage Cylinders (R Series) Double-Acting, Hydraulic-Return — 100-565 Ton Capacity

High-tonnage low cycle, hydraulic return, economy cylinders. (Similar to “Load Return” cylinders with hydraulically powered return.)

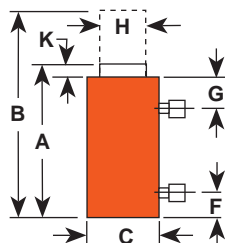

- Cylinders come standard with swivel caps to reduce the effects of off-center loading.
- Cylinders may be “dead-ended” without damage.
- Hard chrome plated, heat treated piston rod provides reduced wear on both piston and gland nut.
- Built-in safety relief valve prevents accidental over-pressurization of the retract circuit.
- Each cylinder has two 9796 3/8" NPTF female half couplers.
- In full compliance with ASME B30.1 standard.
- Integral swivel cap is a standard component on this series of cylinder.



ORDERING INFORMATION

See current price list for shipping weights

Cyl. Cap. (tons)	Stroke (in.)	Order No.	Oil Capacity (cu. in.)		A	B	C	F	G	H	K	Bore Dia. (in.)	Cylinder Effective Area (sq. in.)	Internal Press. at Cap. (psi)	Tons at 10,000 psi (Push)	Prod. Wt. (lbs.)
			Push	Return	Re-tracted Height (in.)	Ex-tended Height (in.)	Outside Dia. (in.)	Base to Port (in.)	Cylinder Top to Port (in.)	Piston Rod Dia. (in.)	Piston Rod Protrusion (in.)					
100	2	R1002D	41.2	19.2	6 ¹ / ₆₄	8 ⁴ / ₆₄	6 ¹ / ₂	1	2 ¹ / ₆₄	3 ³ / ₄	5 ¹ / ₂	5 ¹ / ₈	20.60	9,695	103.0	54
100	6	R1006D	123.6	57.6	10 ⁴ / ₆₄	16 ⁴ / ₆₄	6 ¹ / ₂	1	2 ¹ / ₆₄	3 ³ / ₄	5 ¹ / ₂	5 ¹ / ₈	20.60	9,695	103.0	81
100	10	R10010D	206.0	96.0	14 ⁴ / ₆₄	24 ⁴ / ₆₄	6 ¹ / ₂	1	2 ¹ / ₆₄	3 ³ / ₄	5 ¹ / ₂	5 ¹ / ₈	20.60	9,695	103.0	108
150	2	R1502D	61.4	29.6	7 ¹ / ₁₆	9 ¹ / ₁₆	8 ¹ / ₁₆	1 ¹ / ₄	2 ¹ / ₄	4 ¹ / ₂	1 ⁹ / ₆₄	6 ¹ / ₄	30.70	9,778	153.4	95
150	6	R1506D	184.2	88.8	11 ¹ / ₁₆	17 ¹ / ₁₆	8 ¹ / ₁₆	1 ¹ / ₄	2 ¹ / ₄	4 ¹ / ₂	1 ⁹ / ₆₄	6 ¹ / ₄	30.70	9,778	153.4	136
150	10	R15010D	307.0	148.0	15 ¹ / ₁₆	25 ¹ / ₁₆	8 ¹ / ₁₆	1 ¹ / ₄	2 ¹ / ₄	4 ¹ / ₂	1 ⁹ / ₆₄	6 ¹ / ₄	30.70	9,778	153.4	177
200	2	R2002D	82.6	39.2	8 ³ / ₆₄	10 ³ / ₆₄	9 ¹ / ₄	1 ⁵ / ₈	2 ⁵ / ₁₆	5 ¹ / ₄	1 ¹ / ₃₂	7 ¹ / ₄	41.30	9,690	206.4	136
200	6	R2006D	247.8	117.6	12 ³ / ₆₄	18 ³ / ₆₄	9 ¹ / ₄	1 ⁵ / ₈	2 ⁵ / ₁₆	5 ¹ / ₄	1 ¹ / ₃₂	7 ¹ / ₄	41.30	9,690	206.4	187
200	10	R20010D	413.0	196.0	16 ³ / ₆₄	26 ³ / ₆₄	9 ¹ / ₄	1 ⁵ / ₈	2 ⁵ / ₁₆	5 ¹ / ₄	1 ¹ / ₃₂	7 ¹ / ₄	41.30	9,690	206.4	239
280	2	R2802D	113.4	47.2	9 ³ / ₆₄	11 ³ / ₆₄	10 ³ / ₈	1 ⁷ / ₈	2 ³ / ₆₄	6 ¹ / ₂	1 ³ / ₃₂	8 ¹ / ₂	56.70	9,870	283.7	219
280	6	R2806D	340.2	141.6	13 ³ / ₆₄	19 ³ / ₆₄	10 ³ / ₈	1 ⁷ / ₈	2 ³ / ₆₄	6 ¹ / ₂	1 ³ / ₃₂	8 ¹ / ₂	56.70	9,870	283.7	297
280	10	R28010D	567.0	236.0	17 ³ / ₆₄	27 ³ / ₆₄	10 ³ / ₈	1 ⁷ / ₈	2 ³ / ₆₄	6 ¹ / ₂	1 ³ / ₃₂	8 ¹ / ₂	56.70	9,870	283.7	376
355	2	R3552D	141.8	47.4	11 ¹ / ₈	13 ¹ / ₈	11 ¹ / ₄	2 ¹ / ₈	2 ¹ / ₄	7 ¹ / ₄	7 ¹ / ₁₆	9 ¹ / ₂	70.90	10,017	354.4	324
355	6	R3556D	425.4	142.2	15 ¹ / ₈	21 ¹ / ₈	11 ¹ / ₄	2 ¹ / ₈	2 ¹ / ₄	7 ¹ / ₄	7 ¹ / ₁₆	9 ¹ / ₂	70.90	10,017	354.4	421
355	10	R35510D	709.0	237.0	19 ¹ / ₈	29 ¹ / ₈	11 ¹ / ₄	2 ¹ / ₈	2 ¹ / ₄	7 ¹ / ₄	7 ¹ / ₁₆	9 ¹ / ₂	70.90	10,017	354.4	517
430	2	R4302D	173.2	59.6	12 ¹ / ₁₆	14 ¹ / ₁₆	13	2 ¹ / ₂	2 ⁵ / ₆₄	8 ¹ / ₂	1 ⁵ / ₃₂	10 ¹ / ₂	86.60	9,932	433.0	439
430	6	R4306D	519.6	178.8	16 ¹ / ₁₆	22 ¹ / ₁₆	13	2 ¹ / ₂	2 ⁵ / ₆₄	8 ¹ / ₂	1 ⁵ / ₃₂	10 ¹ / ₂	86.60	9,932	433.0	558
430	10	R43010D	866.0	298.0	20 ¹ / ₁₆	30 ¹ / ₁₆	13	2 ¹ / ₂	2 ⁵ / ₆₄	8 ¹ / ₂	1 ⁵ / ₃₂	10 ¹ / ₂	86.60	9,932	433.0	673
565	2	R5652D	226.2	76.8	13 ¹ / ₃₂	15 ¹ / ₃₂	14 ¹ / ₈	2 ¹ / ₄	3 ¹ / ₆₄	9 ¹ / ₄	3 ³ / ₆₄	12	113.10	9,991	565.5	619
565	6	R5656D	678.6	230.4	17 ¹ / ₃₂	23 ¹ / ₃₂	14 ¹ / ₈	2 ¹ / ₄	3 ¹ / ₆₄	9 ¹ / ₄	3 ³ / ₆₄	12	113.10	9,991	565.5	772
565	10	R56510D	1131.0	384.0	21 ¹ / ₃₂	31 ¹ / ₃₂	14 ¹ / ₈	2 ¹ / ₄	3 ¹ / ₆₄	9 ¹ / ₄	3 ³ / ₆₄	12	113.10	9,991	565.5	926